



**LYCÉE INTERNATIONAL DE
INTERNATIONAL SCHOOL OF
BOSTON**

Teaching the World

PRESCHOOL & KINDERGARTEN

PRE-K (3-YEAR-OLD PROGRAM) • MID-K (4-YEAR-OLD PROGRAM) • K (5-YEAR-OLD PROGRAM)



A UNIQUE LEARNING ENVIRONMENT

ISB's Maternelle—Preschool and Kindergarten—offers a distinctive and unique bilingual (French and English) environment beginning at age 3. Daily activities establish the foundation for all future learning and give your children the opportunity to safely explore the world around them. Art, music, drama and gross-motor skills activities allow children to discover their innate abilities to feel, act, question, reflect and imagine.

Some children enter our Preschool speaking hardly any English, and knowing little or no French. They speak a third language at home which adds diversity to our classrooms. French and English are not required to enter ISB, but we suggest that non-francophone children begin the program as early as possible. Our teachers understand that acquiring a new language is a process that takes time and they work with the students every day, often collaboratively, to foster a bilingual learning environment.

Based on the official French national curriculum, the Maternelle program provides a well-planned pedagogical approach to children at a young age, one that is

maintained and reinforced each year at ISB. The program focuses on the following areas:

1. Using language in all its dimensions (both oral and written)
2. Acting, expressing and understanding through physical activity
3. Acting, expressing and understanding through art
4. Developing the first tools to structure thoughts
5. Exploring the world

In addition to the regular school day, the Maternelle offers both an extracurricular program (Monday–Friday) that includes a wide array of activities, as well as vacation programs when school is not in session.

When it is finally time to move on, Maternelle students begin Lower School with a great sense of resourcefulness and independence, thanks to their blossoming bilingualism and their increased confidence and self-esteem.



LOWER SCHOOL

GRADES 1 THROUGH 5



BUILDING A SOLID FOUNDATION IN BOTH FRENCH AND ENGLISH

Lower School is one of the most exciting and foundational periods in our young students' lives. It is when we celebrate and explore their natural curiosity and acceptance of new ideas as we build a solid foundation of skills through our interdisciplinary, bilingual approach to learning.

Lower School includes grades 1 through 5, or CP through CM2 in the French educational system. Led by passionate, engaged, and culturally diverse and competent teachers, Lower School's dual-language curriculum incorporates reading and writing, mathematics, sciences, social studies, the arts, information technology and physical education.

During a student's first two years in the Lower School, the focus is on expanding their knowledge of French. After 2nd grade, the curriculum transitions from an emphasis on French to a more balanced program—approximately 50% of the program is in French and 50% is in English. This balance continues through the 5th grade. To further support our students on this road to bilingualism, everyone in the Lower School embraces the philosophy that all teachers, regardless of subject, are language teachers.

French is not required for entry in the Lower School.

BUILDING AN INTERNATIONAL COMMUNITY

As students are adapting to their ever-increasing language skills and the academic challenges of the Lower School, they are also mastering how to effectively interact and work with their international classmates. In so doing, they develop the ability to see a problem from differing viewpoints.

By the end of 5th grade, Lower School students advance with not only a high level of bilingualism and academic competence, but also a sincere appreciation and understanding of different cultures.



MIDDLE SCHOOL

GRADES 6 THROUGH 8



A DUAL LANGUAGE PROGRAM

In the 6th through 8th grades, Middle School students follow a dual language program that is in line with the official program of the French Ministry of Education. Students take academic classes taught in French and English and thus don't merely learn two languages but rather *learn in two languages*. Students think, reason, and communicate in French and English, enhancing their critical thinking skills and intellectual flexibility. The majority of students are fluent in both French and English and take native-level language courses. Students who are still in the process of acquiring either French or

English receive small group instruction appropriate to their level of language acquisition. The goal is for those students to slowly integrate into the native-level courses as they progress in their second language. In the 6th grade, students begin to learn a third language, Spanish or German, and in 8th grade, they may add a fourth language, Latin.

French is not required for entry in the Middle School.

ENRICHING THE MIDDLE SCHOOL EXPERIENCE

The Middle School experience at ISB is enriched through the **Student Exploration Program**, a project-based hands-on learning experience. Each semester teams of 6th, 7th, and 8th grade students explore a theme or topic in a weekly two-hour session. Topics are very diverse and include Robotics, Health and Wellness, Design Thinking, and "Into the Wild." Under the mentorship of a faculty member, students plan and create a project related to the larger topic. Each semester includes a field trip, or "Exploration Day," when all Middle School students have the chance to explore the many wonderful resources around the city of Boston, ranging from a robotics workshop at M.I.T. to a lobster boat in Plymouth Harbor.

The Middle School program is further enriched through interdisciplinary projects, local and overnight field trips, as well as partnerships with area universities. The Advisory and Wellness Programs are the foundation of our strong community and support students in learning to make healthy and productive choices. Art, Drama, Music, and Physical Education round out the program and offer the students opportunities to be both creative and active.



UPPER SCHOOL

GRADES 9 THROUGH 12



Upper School prepares students to thrive in universities across every continent, embracing the unique challenges and boundless opportunities of our interconnected world.

In addition to its truly international student body and faculty, we are the only school in New England that not only offers an American High School diploma, but also gives our Upper School students the choice between two internationally recognized diplomas: the **French Baccalaureate** taught in French or the **International Baccalaureate (IB)** taught in English.

CHOOSE BETWEEN TWO INTERNATIONALLY RECOGNIZED DIPLOMAS

FRENCH BACCALAUREATE TRACK

Created in 1808, the French Baccalaureate (the *Baccalauréat* in France) is administered and managed by the French Ministry of Education. The program ensures broad general and cultural knowledge by the number and variety of its required subjects.

In France, the Baccalaureate is considered the first university level diploma. This is why the Bachelor degree in France is granted after three years, while in the U.S. it takes four years. Recognized as one of the most demanding programs, the French Baccalaureate gives graduates access, and often credits, to higher education systems worldwide.

In the 11th grade, students choose between three core areas of study—Economics and Social Sciences, Literature and Philosophy, Sciences and Mathematics. Students may also choose the *Option Internationale du Baccalauréat* (OIB). The OIB offers a bilingual and bicultural syllabus within the framework of the classic French curriculum. This option is especially interesting to our students who are fully bilingual in French and English.

INTERNATIONAL BACCALAUREATE (IB) TRACK

The International Baccalaureate (IB) program also officially begins in the 11th grade. Taught in more than 4100 schools worldwide, the IB is globally recognized for its unique combination of academic rigor and emphasis on each student's personal development. IB students are encouraged to think independently and drive their learning. Furthermore, the IB aims to do more than other curricula by developing inquiring, knowledgeable, and caring young people who are motivated to succeed.

9th grade students who wish to pursue the IB enroll in the International Program (IP). Other than foreign language classes and the possibility of taking science in French, all of the International Program's classes are taught in English. 9th and 10th grade students research global issues and, through the Model United Nations (MUN) class, gain an in-depth understanding of the functions of the United Nations, parliamentary procedure, speechmaking, and working in committees. The MUN class participates in at least three regional Model UN conferences each year. This class is in addition to core classes in Math, Science, World Languages, English Literature, Art, Music, and Theater.



UPPER SCHOOL

GRADES 9 THROUGH 12



OUTREACH & TRAVEL

All ISB Upper School students are required to take part in service activities and encouraged to invest their time in creative, active and service-based projects. In addition to community service, Upper School students participate in The Global Issues Program (GIP), which helps International Program students become active global citizens by focusing on developing international mindedness, research, thinking, communication and self-regulation skills.

ISB not only teaches the world, but also gives students the opportunity to travel the world. We have developed exchange programs with Argentina, Martinique, the

Netherlands and Austria, while also coordinating several community trips to places such as Vietnam, Peru and New Orleans. In addition, ISB students have led culturally immersive trips to China, Spain, and Iceland.

Our graduates attend universities around the world, thanks to our international approach to College Counseling. ISB is well known locally and nationally, but also has relationships with the best universities around the world. Our graduates have attended universities throughout the United States, Canada, the United Kingdom, France, Ireland, Spain, Germany, and Australia.

IMMERSIVE HOMESTAYS AT ISB

Each year, ISB offers several I-20 Visas to exceptional high school students from around the world. These students are welcomed into our community and reside with a local family, as arranged by ISB. Our warm, safe and comfortable households open their doors to international students for one or more years and give them a truly immersive experience!

Homestay students are offered additional support on and off campus through our Homestay Coordinator. These supports range from organizing ESL needs, doctor visits, communication with families, Visa help and more.

Students interested in our Homestay Program should apply by following the process for all Upper School applicants (for non-native speakers of English, we

require the TOEFL). We encourage students, if possible, to visit the school. Otherwise, we organize a Skype conversation to both assess the student's level of English and determine their interest in ISB.

Once a student is accepted, ISB will begin the process of applying for a student Visa as well as organizing the homestay. All students are asked to complete a comprehensive homestay questionnaire with the goal of placing each student in a home that is the best fit.

All homestay students attend an initial orientation—a time to meet new classmates, learn about life in Boston, and life at ISB. This orientation is scheduled up to a week or few days prior to the start of the school year.



FACTS & FIGURES

ISB MISSION

We cultivate excellence through French-English bilingual and multicultural learning.

HISTORY

1962 Founded as a French language Kindergarten and expanded quickly into a bilingual elementary school.

1983 Moved into the historic Parmenter School building in Arlington.

1997 Opened the 19th century historic building in Cambridge, after making the decision to open the Middle School.

1999 Began the Upper School. The first graduating class to earn their French Baccalaureate was in 2001.

2006 Added the International Baccalaureate (IB) Diploma Program, graduating the first IB class in 2006.

2019 Consolidated the ISB Maternelle, Lower, Middle and Upper Schools onto one campus, moving the Maternelle from Arlington to the Cambridge Campus.

One Campus

Maternelle
Preschool (starting at age 2.9) to K

Lower School
Grades 1–5

Middle School
Grades 6–8

Upper School
Grades 9–12

6:1 Student to Faculty Ratio



Over 75% of faculty hold advanced degrees



FACTS & FIGURES

575 Students Enrolled

Maternelle = 90 students

Lower School = 230 students

Middle School = 125 students

Upper School = 130 students

Student Diversity

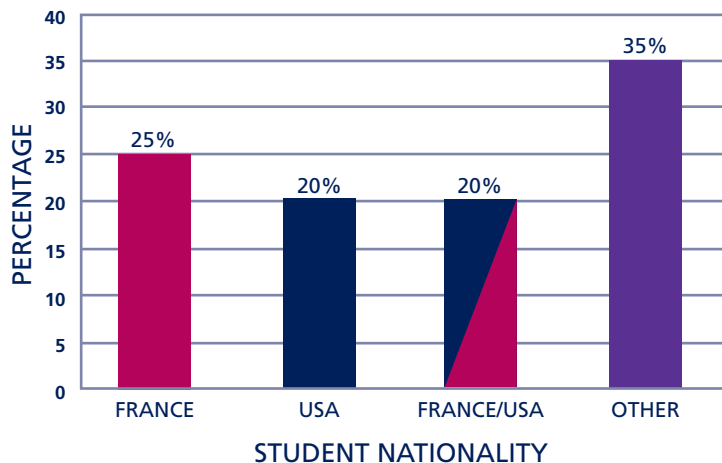

Over **40 countries** represented

Over **30 languages** spoken

Examinations

ISB graduates are awarded a **High School Diploma** and earn either the **French Baccalaureate** or the **International Baccalaureate**.

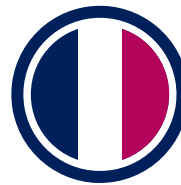

Financial Assistance

23% of students receive ISB financial aid or French bourse



2019–20 CALENDAR

SEPTEMBER	2	Monday (Holiday)	Labor Day (no classes)
	3	Tuesday Afternoon	Orientation 1–3 pm
	4	Wednesday	First Day of Classes for all Students
OCTOBER	14	Monday (Holiday)	Indigenous People's Day (no classes; In-Service for Faculty)
	18	Friday (after 6 pm)	Fall Vacation
	28	Monday	Classes Resume
NOVEMBER	26	Tuesday (after 6 pm)	Thanksgiving Recess (no classes)
DECEMBER	2	Monday	Classes Resume
	19	Thursday (after 6 pm)	End of Year Vacation
JANUARY	6	Monday	Classes Resume
	20	Monday (Holiday)	Martin Luther King, Jr. Day (no classes)
	21	Tuesday	Faculty In-Service Day (no classes)
FEBRUARY	14	Friday (after 6 pm)	Winter Vacation
	24	Monday	Classes Resume
MARCH	20	Wednesday	Faculty In-Service Day (no classes)
APRIL	17	Friday (after 6 pm)	Spring Vacation
	27	Monday	Classes Resume
MAY	25	Monday (Holiday)	Memorial Day (no classes)
JUNE	17	Wednesday	Dismissal for Summer Vacation at 12 pm

CAMPUS MAP

INTERNATIONAL SCHOOL OF BOSTON

Preschool through Grade 12

45 Matignon Road, Cambridge, MA 02140

Tel: 617-499-1459 • Fax: 617-234-0064

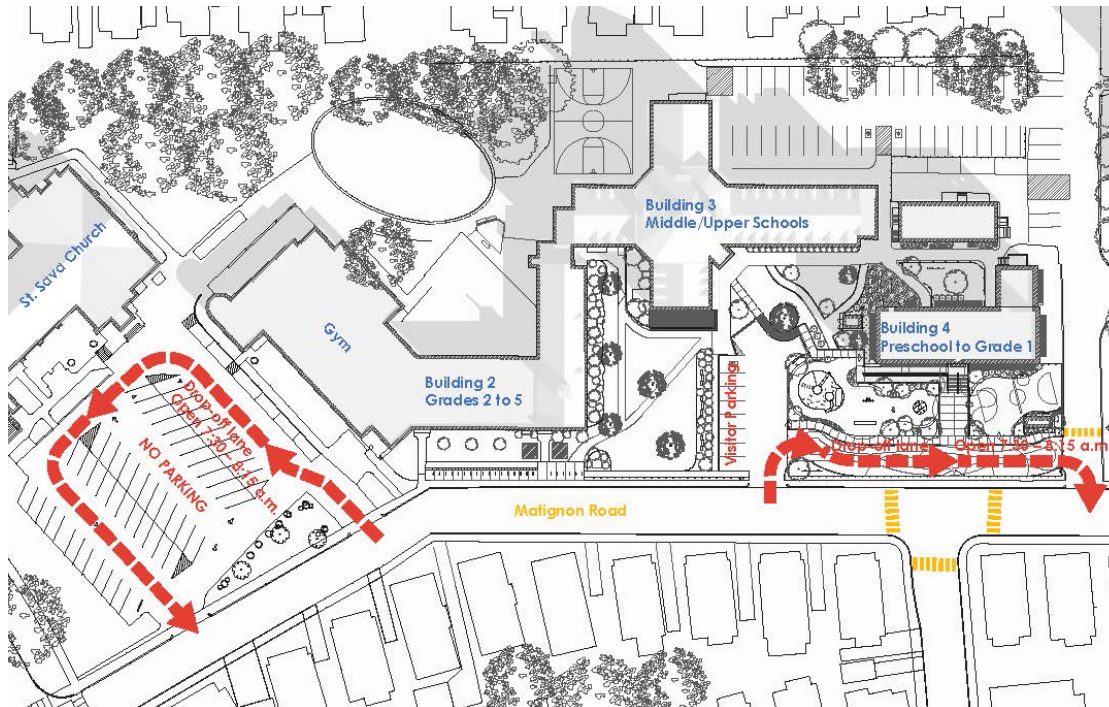

TRANSPORTATION

ISB private bus lines:

Route #1: Brookline–Fenway–Back Bay–Charlestown–Davis Square

Route #2: Newton–Waltham–Lexington–Belmont–Arlington

MBTA bus stops:

On Massachusetts Avenue by Churchill Avenue: Bus # 77 Arlington Heights–Harvard

On Broadway Avenue by Endicott Street: Buses # 87-88-89

Clarendon Hill or Arlington Center–Sullivan or Lechmere

Cambridge Public Schools bus:

Students aged 4 through Grade 8 with a home address in Cambridge can also ride the Cambridge Public Schools bus.



ADMISSIONS & ENROLLMENT

SCHOOL YEAR 2019–20



ADMISSIONS & ENROLLMENT PROCESS

The **International School of Boston** has implemented an online application and enrollment process. Once we have received your application and verified your child's academic records, the Admissions Office will facilitate a visit to the ISB campus and conduct an interview on site so that we may get to know your family. For applicants from abroad or out of state, the interview will take place via Skype, once the application file is complete.

The general deadline for applications is FEBRUARY 15th. However, in recognition of international mobility, the application and enrollment process takes place on a rolling basis according to space availability.

Admissions decisions for all applications received by February 15th are sent to families in March, via e-mail. Students who have been placed on a waiting list will be accepted when places become available.

Please note:

- **Siblings and children of Alumni** are given priority in the admissions process if their application is received before **DECEMBER 31st**. Admissions decisions are e-mailed to families at the time of re-enrollment, mid-February.
- Students applying to Pre-Kindergarten must be three years old by December 31st of their entry year. Students must be fully toilet-trained before entering school.

Whenever possible, we strongly recommend that applicants attend an Open House or an Information Night. They are usually scheduled between October and January.

When considering an applicant we recognize that every child is unique. However, we evaluate the applicant's overall academic and developmental readiness for the grade he/she is applying to and whether he/she will thrive in and benefit from the academic challenges of a bilingual curriculum. We also consider the family's commitment to ISB's mission and program, and to its distinct multicultural and diverse setting.

HAVE QUESTIONS?

If you have any questions at any time throughout the Admissions & Enrollment Process, the Admissions Office is available Monday through Friday and welcomes your calls or your emails. We are here to support you and your family.

Lucy Pelham

Director of Admissions & Enrollment Management
lpelham@isbos.org, 617.499.1459

Elisabeth Geffray

Assistant Director of Admissions
egeffray@isbos.org, 617.583.9231

Victor Ng

Finance & Administration Manager
vng@isbos.org, 617.583.9212



TUITION AND FEES

SCHOOL YEAR 2019–20



GRADES	ANNUAL TUITION	
Preschool & Kindergarten: Pre-K, Mid-K and K	\$25,200	All supplies are included.
Lower School: Grades 1 to 5	\$27,900	Textbooks and Notebooks are included.
Middle School: Grades 6 to 8	\$29,450	Textbooks/Media are billed separately.
Upper School: Grades 9 and 10	\$34,000	Textbooks/Media are billed separately.
Upper School: Grades 11 and 12	\$35,500	Textbooks/Media and Examination Fees are billed separately (PSAT Testing Fee included).

The above rates do not apply when the tuition is paid by an employer or company linked with the student's family. Please contact Victor Ng at vng@isbos.org for more information on the relevant rates and terms.

MATRICULATION FEE, DEPOSIT AND TUITION PAYMENTS

MATRICULATION FEE

One-time, non-refundable,
not applicable towards tuition

\$2,000 per new student

\$1,500 for the second child

\$1,000 for any additional children

RE-ENROLLMENT DEPOSIT

Non-refundable, applied towards tuition

\$2,000 per student

TUITION PAYMENT SCHEDULE

OPTION 1:

Payment of tuition in full by June 5th

OPTION 2:

Payment of tuition in two installments:
60% by June 5th, 40% by November 5th

OPTION 3:

Payment of tuition in 10 installments from June 2019
to March 2020; a yearly flat fee of \$50, billed by TADS

All matriculation fees, deposit and tuition payments must be sent to **TADS**. Methods of payment accepted: checking/savings account drawn on a U.S. bank, wire transfer, and credit cards.



TUITION AND FEES

SCHOOL YEAR 2019–20

OTHER FEES

APPLICATION FEE

\$50 per child (non-refundable), payable by check drawn on a U.S. bank, or by credit card on our website. Applications are valid for two years.

TEXTBOOKS & EXAMINATION FEES

Textbooks/Media (grades 6–12) and **Examination Fees** (grades 11 and 12): billed separately according to grade, program and options.

Estimate of Textbooks/Media Prices

- **Grades 6–10 & Grades 11–12**
French Program only: \$300–\$600 per year
- **Grades 11–12 International Baccalaureate:**
up to \$1,000 covering two years

Estimate of Examination Fees

- **SAT fees:**
<http://professionals.collegeboard.com/testing>
- **Grade 11 French Program:** \$225 registration fee
- **Grade 12 French Program:** \$265 registration fee, plus \$200 for the International Option of the Baccalauréat (OIB), plus \$80 per other optional test
- **Grade 12 International Baccalaureate:**
\$172 registration fee, plus \$119 per subject

HOT LUNCH PROGRAM

Option of 2, 3 or 5 days/week, billed separately, by semester, approximately **\$1,000 to \$1,500/year** for the full week option depending on the grade of the student.

EXTENDED DAY

Garderie—Pre-K to grade 5: **\$11.00/hr**

STUDY HALL

Middle School: **\$15.00/hr**; or annual flat fee: **\$600.00**

ADDITIONAL LEARNING SUPPORT:

Depending on the recommendations of our Learning Support Department, a fee may apply when the needs of the student require additional services than ordinarily provided.

EXTRACURRICULAR ACTIVITIES/ OVERNIGHT TRIPS

Activities and trips organized by the school are billed upon participation.

BUS SERVICE

Private ISB Bus Service is billed upon participation.

ISB HOUSING PROGRAM:

International students staying with host families:
\$18,000

Room and board with host family, from August 26th to June 30th, supervised by ISB.

Includes the Hot Lunch Program 5 days/week, one ISB extracurricular activity per trimester, monthly T-pass, College Tour, SAT Prep, yearbook and Orientation Program in August for **new** students entering the IP/IB Programs (mandatory).

ISB FINANCIAL AID PROGRAM / FRENCH GOVERNMENT FINANCIAL AID

Need-based financial aid is available for qualifying families through the **ISB Financial Aid Program**.

Students holding French citizenship and demonstrating a need for financial assistance might qualify for the ***Bourses Scolaires Françaises***, allocated by the French government. Also, the ISB Financial Aid Program may supplement the amount granted by the French government. Families are asked to **simultaneously**

apply for the *Bourses Scolaires Françaises* and ISB Financial Aid, but the ISB Financial Aid Application will only be reviewed once the family receives the decision from the French government.

All families with 3 or more children enrolled at ISB, regardless of their nationalities, may contact Victor Ng, Finance & Administration Manager, to learn more about possible ISB Financial Assistance (vng@isbos.org).

CONTACT

ISB ADMISSIONS OFFICE
FOR PRE-K TO 12TH GRADE

45 Matignon Road

Cambridge, MA 02140

617.499.1459 / admissions@isbos.org

WWW.ISBOS.ORG